

Carcass Front

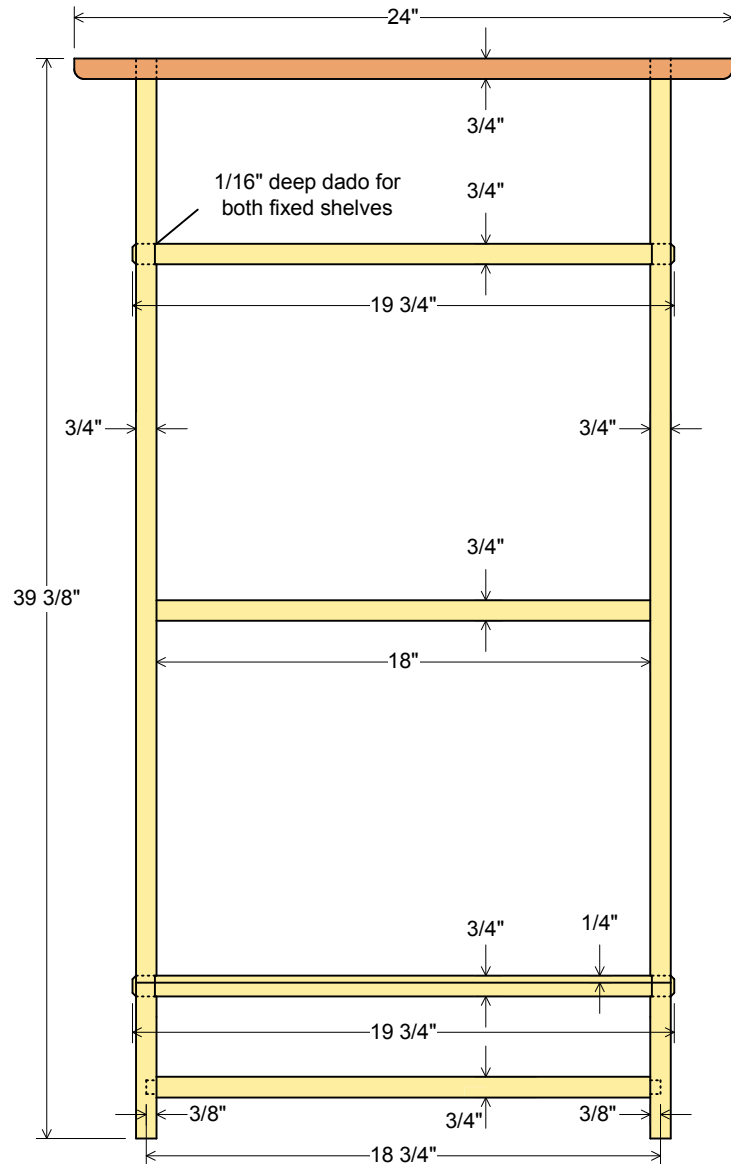

Carcass Side

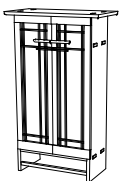
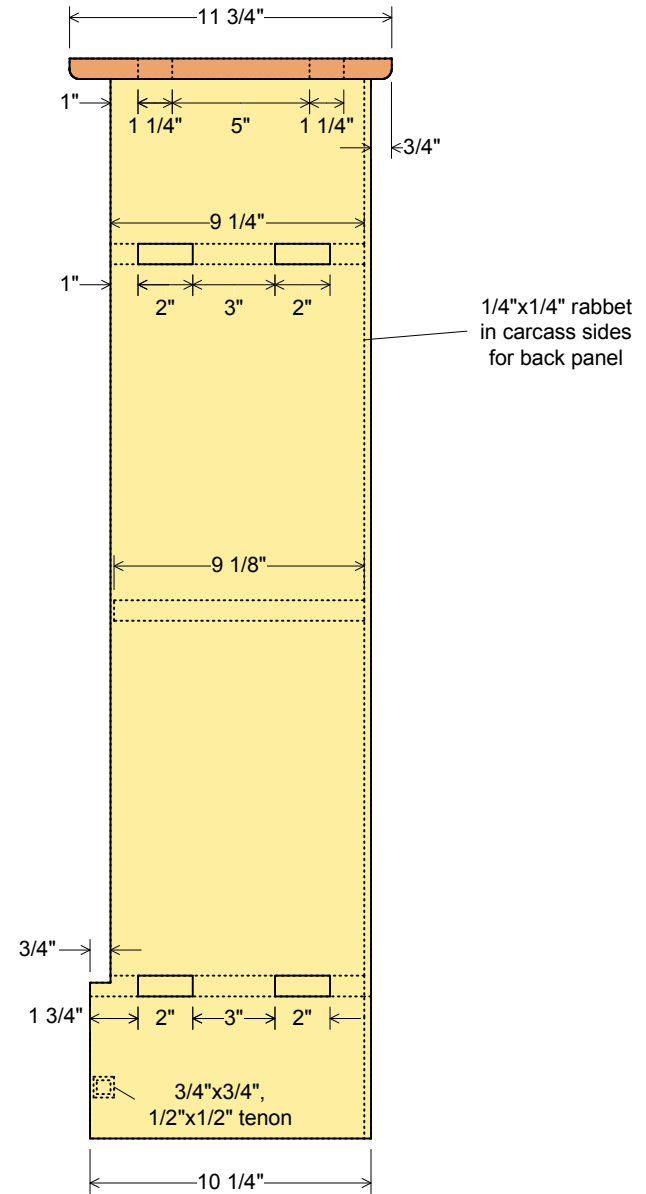

Door Details

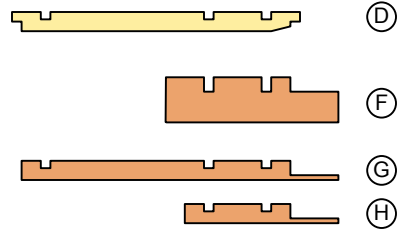
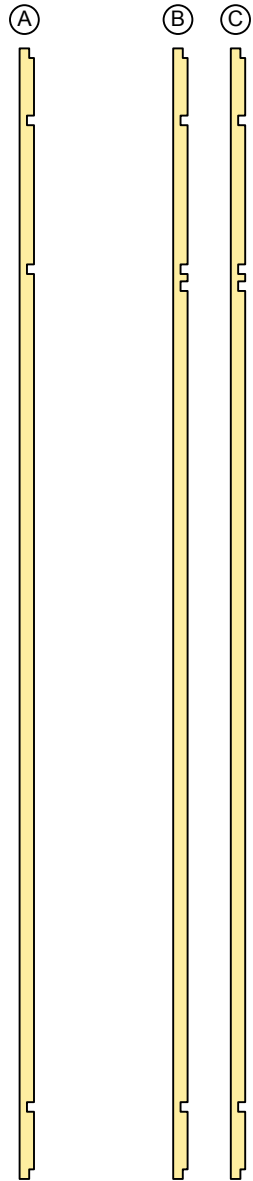

Vertical Details (A, B, C)

Dimensions: $29 \frac{7}{16} \times 3/8 \times 1/4$ "

End Tenons:

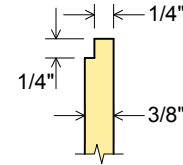

Half Lap Joints (at D, E, G, H):

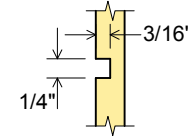

Horizontal Details (D, E)

Dimensions: $7 \frac{1}{2} \times 1/2 \times 1/4$ "

Outer Stile Tenons:

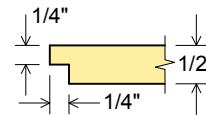

Half Lap Joints:

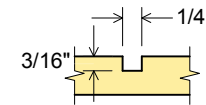

Inner Stile Tenons:

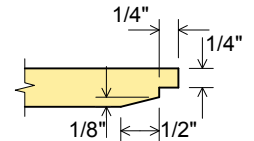

Handle Details (G, H)

Dimensions - G: $8 \frac{1}{4} \times 1/2 \times 1/4$ "

H: $4 \times 1/2 \times 1/4$ "

Half Lap Joints (at A, B, C):

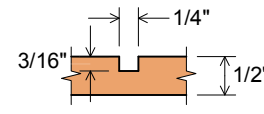

Inner Stile Lap Joint:

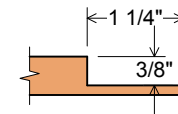

Handle (F)

